

Official Zoning Map

Map prepared by Worcester County Department of Development Review and Permitting, November 3, 2009.
 Source: Worcester County Commissioners.

| | | | | | | | | | | | |
|--|----|--|----|--|----|--|----|--|----|--|-----|
| | A1 | | RP | | R2 | | I1 | | C1 | | V1 |
| | A2 | | E1 | | R3 | | I2 | | C2 | | MUN |
| | CA | | R1 | | R4 | | CM | | C3 | | |

Tax Map 11

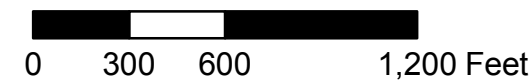
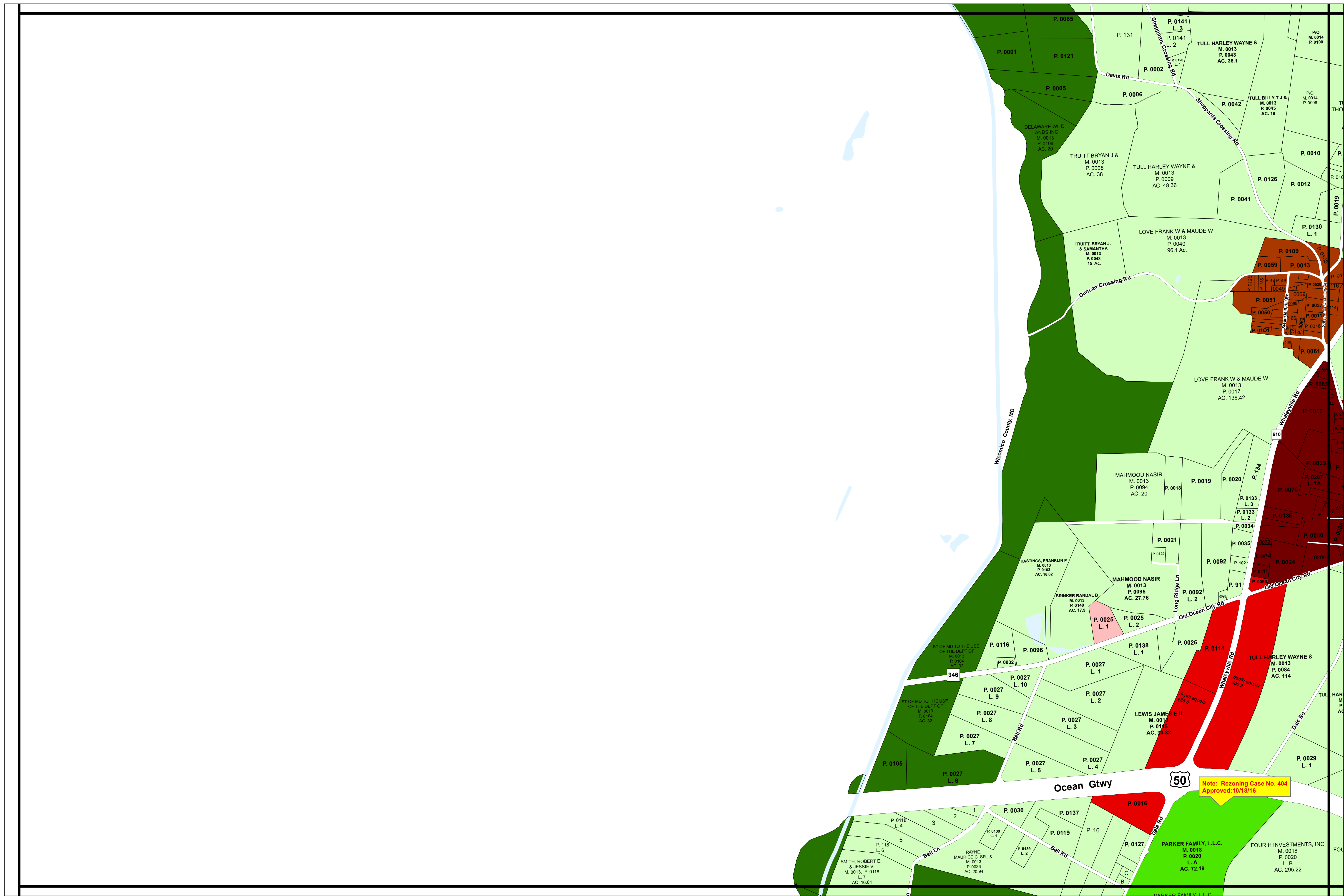

Official Zoning Map

Map prepared by Worcester County Department of Development Review and Permitting, November 3, 2009.
 Source: Worcester County Commissioners; UPDATED: Resolution No. 16-06.
 NOTE: Resolution 16-06 references Map 13, Parcel 20, Lot A, Case No. 404, effective 10/18/16.

| | | | | | |
|----|----|----|----|----|-----|
| A1 | RP | R2 | I1 | C1 | V1 |
| A2 | E1 | R3 | I2 | C2 | MUN |
| CA | R1 | R4 | CM | C3 | |

Tax Map 13

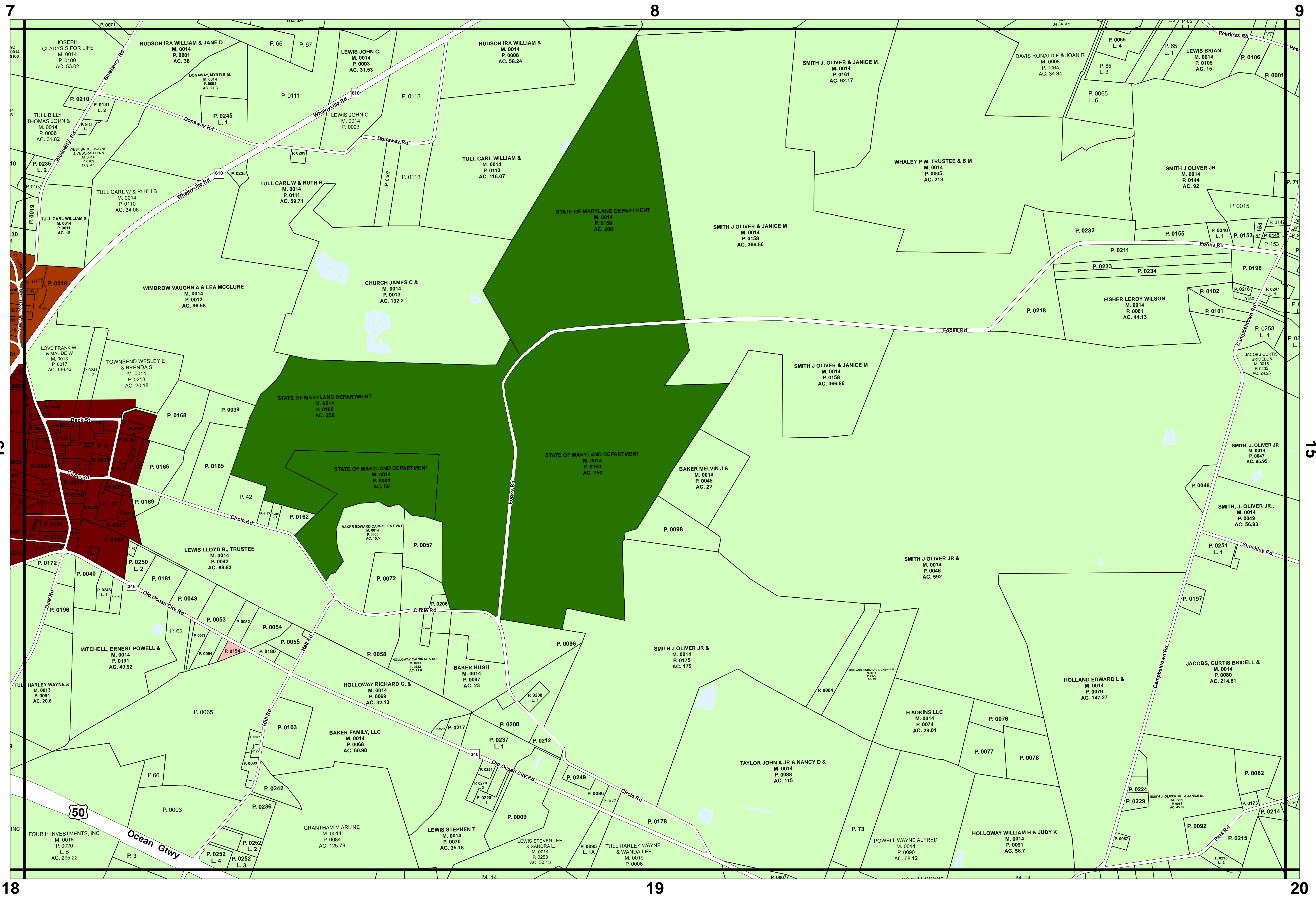

0 300 600 1,200 Feet

Official Zoning Map

Map prepared by Worcester County Department of Development Review and Permitting, November 3, 2009.
 Source: Worcester County Commissioners.

| | | | | | | | | | | | |
|--|----|--|----|--|----|--|----|--|----|--|-----|
| | A1 | | RP | | R2 | | I1 | | C1 | | V1 |
| | A2 | | E1 | | R3 | | I2 | | C2 | | MUN |
| | CA | | R1 | | R4 | | CM | | C3 | | |

Tax Map 14

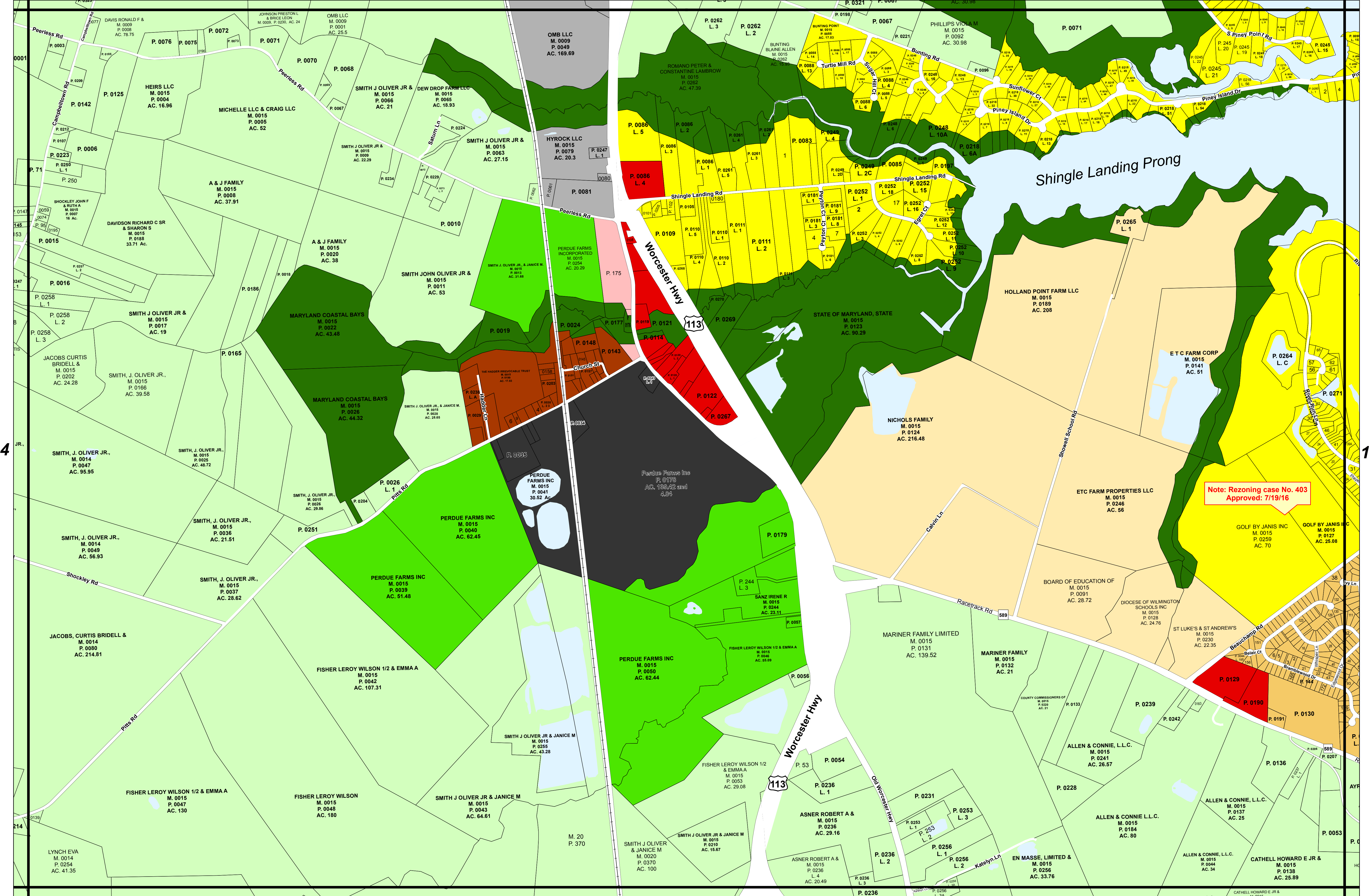

0 300 600 1,200 Feet

Official Zoning Map

Map prepared by Worcester County Department of Development Review and Permitting, November 3, 2009.
 Source: Worcester County Commissioners; UPDATED: Resolution No. 16-05.
 NOTE: Resolution 16-05 references Map 15, Parcels 127 and 259, Case No. 403, effective 7/19/16.

| | | | | | | | | | | | |
|--|----|--|----|--|----|--|----|--|----|--|-----|
| | A1 | | RP | | R2 | | I1 | | C1 | | V1 |
| | A2 | | E1 | | R3 | | I2 | | C2 | | MUN |
| | CA | | R1 | | R4 | | CM | | C3 | | |

Tax Map 15

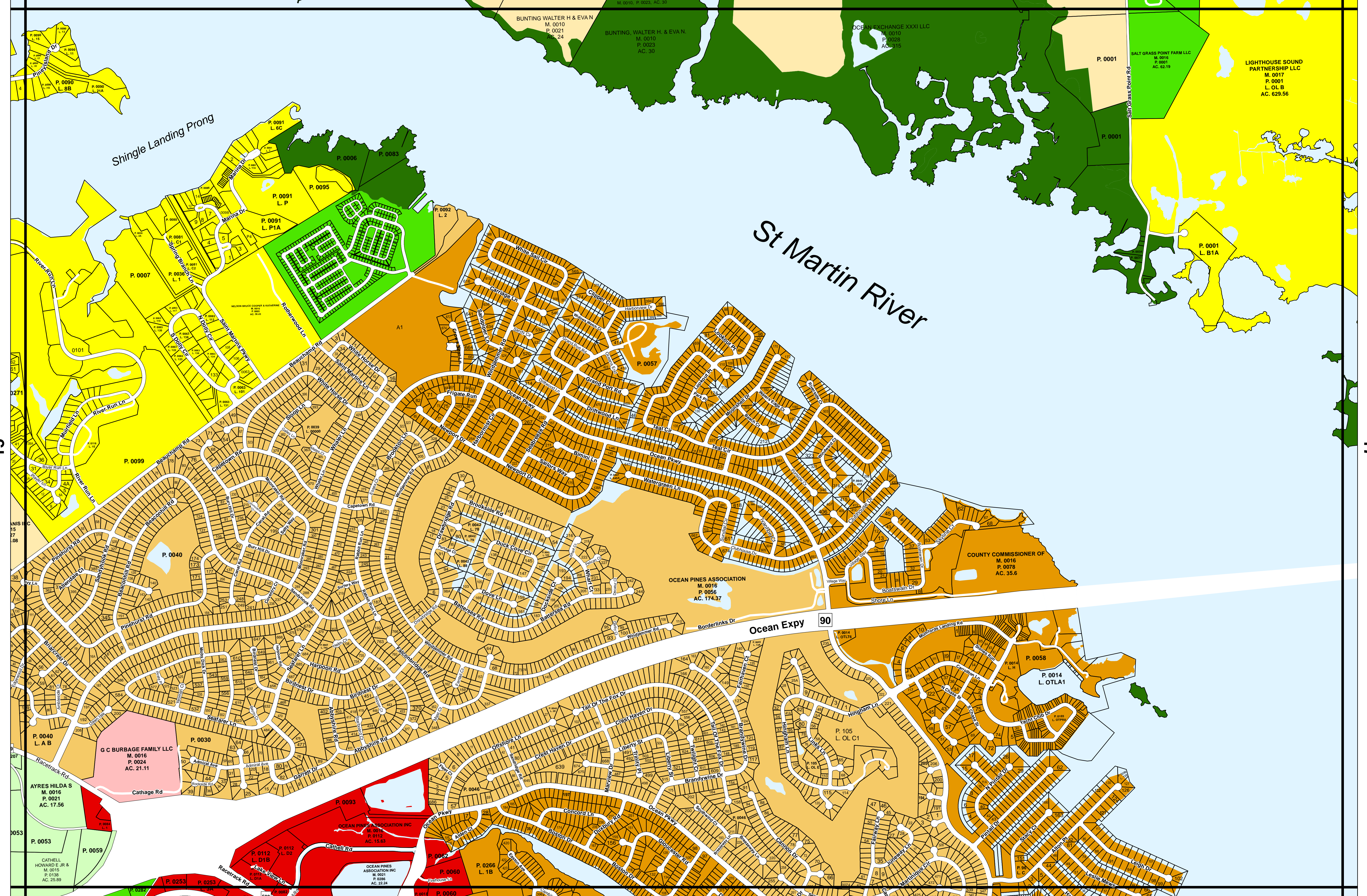

0 300 600 1,200 Feet

Official Zoning Map

Map prepared by Worcester County Department of Development Review and Permitting, November 3, 2009.
Source: Worcester County Commissioners.

| | | | | | |
|----|----|----|----|----|-----|
| A1 | RP | R2 | I1 | C1 | V1 |
| A2 | E1 | R3 | I2 | C2 | MUN |
| CA | R1 | R4 | CM | C3 | |

Tax Map 16

10

11

115

16

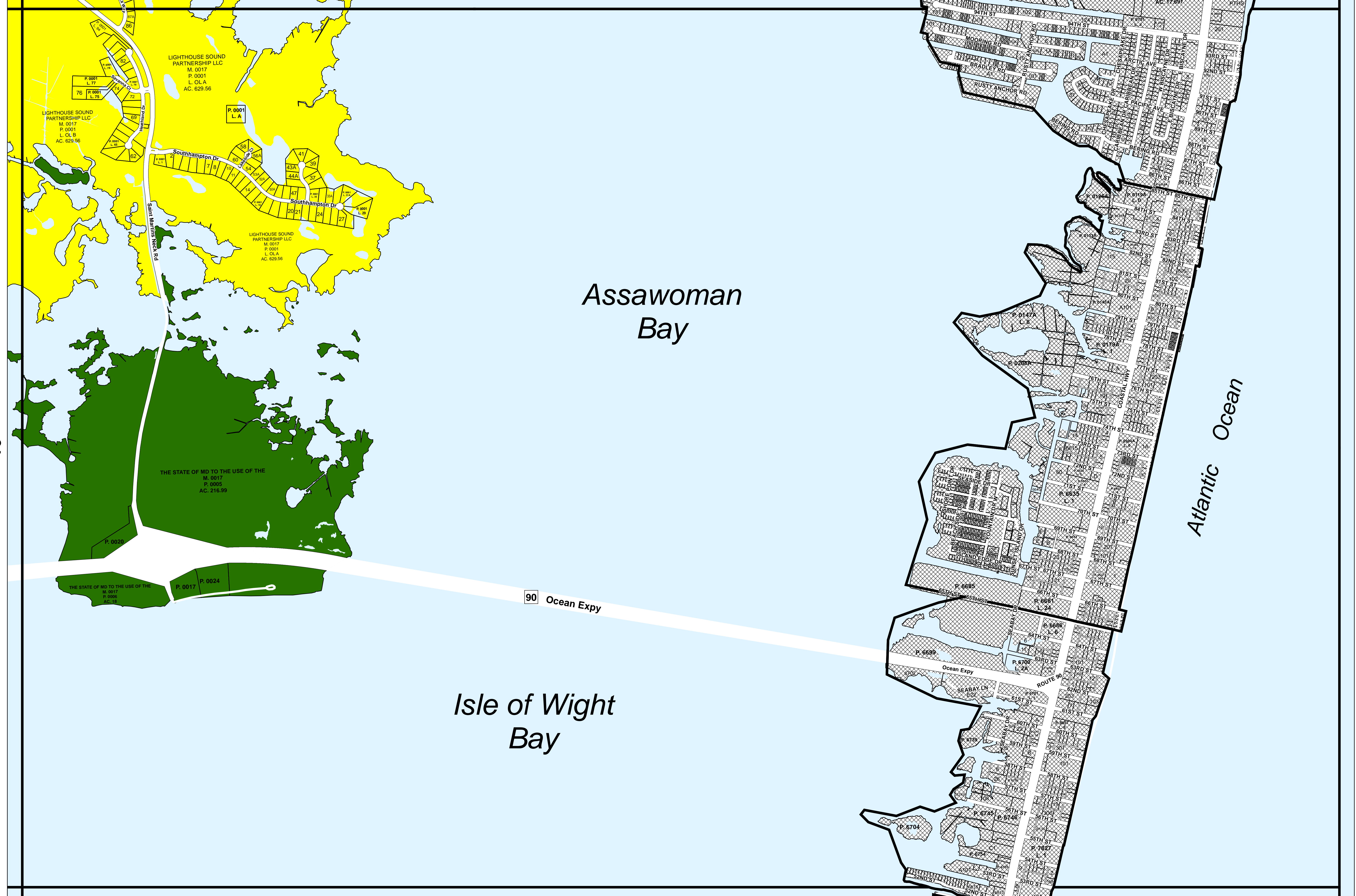

Assawoman Bay

Atlantic Ocean

Isle of Wight Bay

90 Ocean Expy

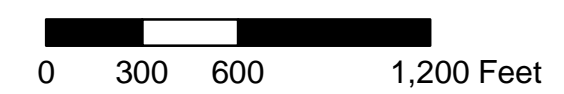

Official Zoning Map

Map prepared by Worcester County Department of Development Review and Permitting, November 3, 2009. Source: Worcester County Commissioners.

| | | | | | |
|----|----|----|----|----|-----|
| A1 | RP | R2 | I1 | C1 | V1 |
| A2 | E1 | R3 | I2 | C2 | MUN |
| CA | R1 | R4 | CM | C3 | |

Tax Map 17

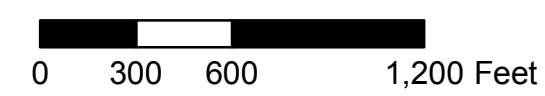
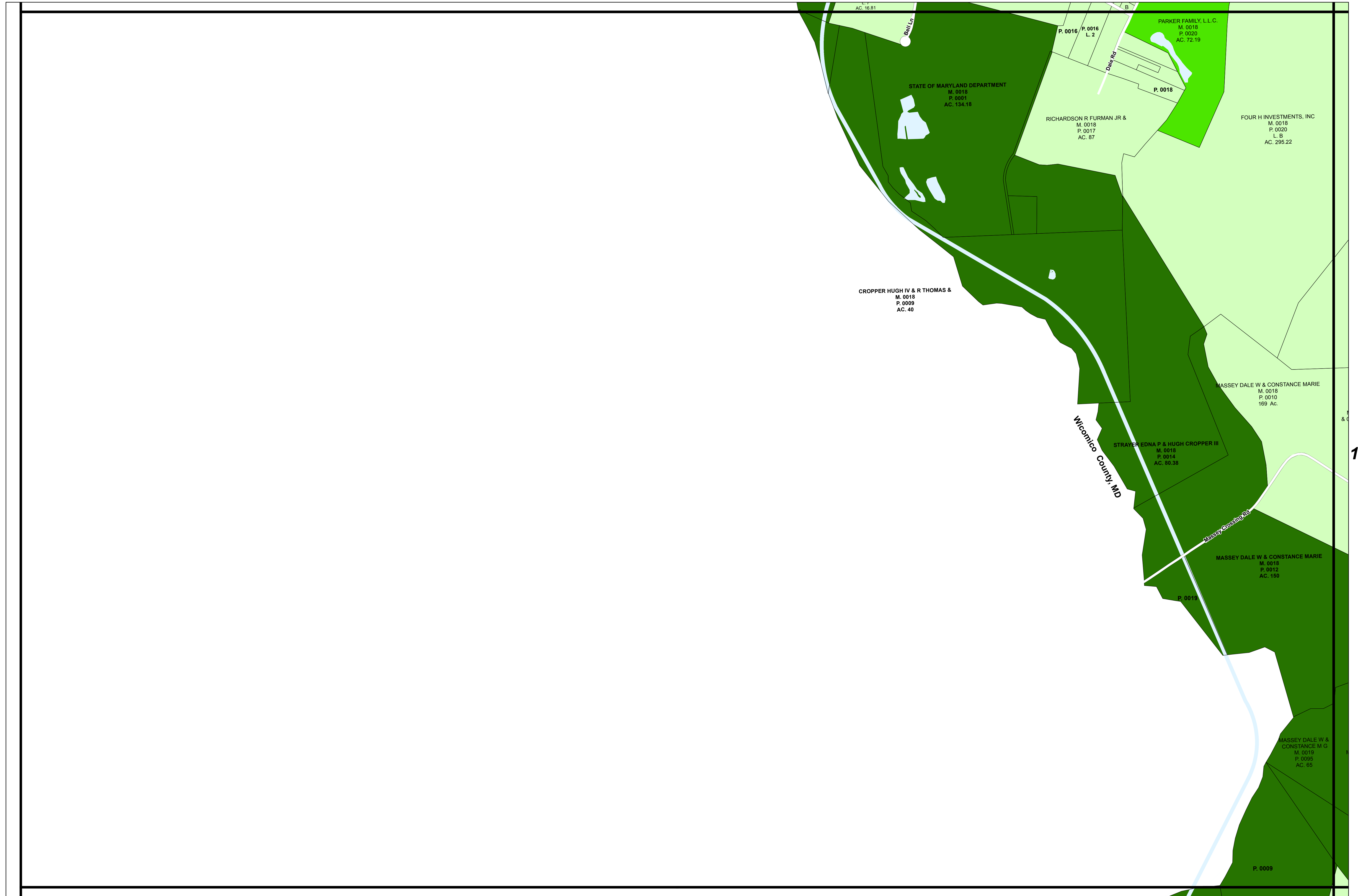

Official Zoning Map

Map prepared by Worcester County Department of Development Review and Permitting, November 3, 2009.
Source: Worcester County Commissioners.

| | | | | | | | | | | | |
|--|----|--|----|--|----|--|----|--|----|--|-----|
| | A1 | | RP | | R2 | | I1 | | C1 | | V1 |
| | A2 | | E1 | | R3 | | I2 | | C2 | | MUN |
| | CA | | R1 | | R4 | | CM | | C3 | | |

Tax Map 18

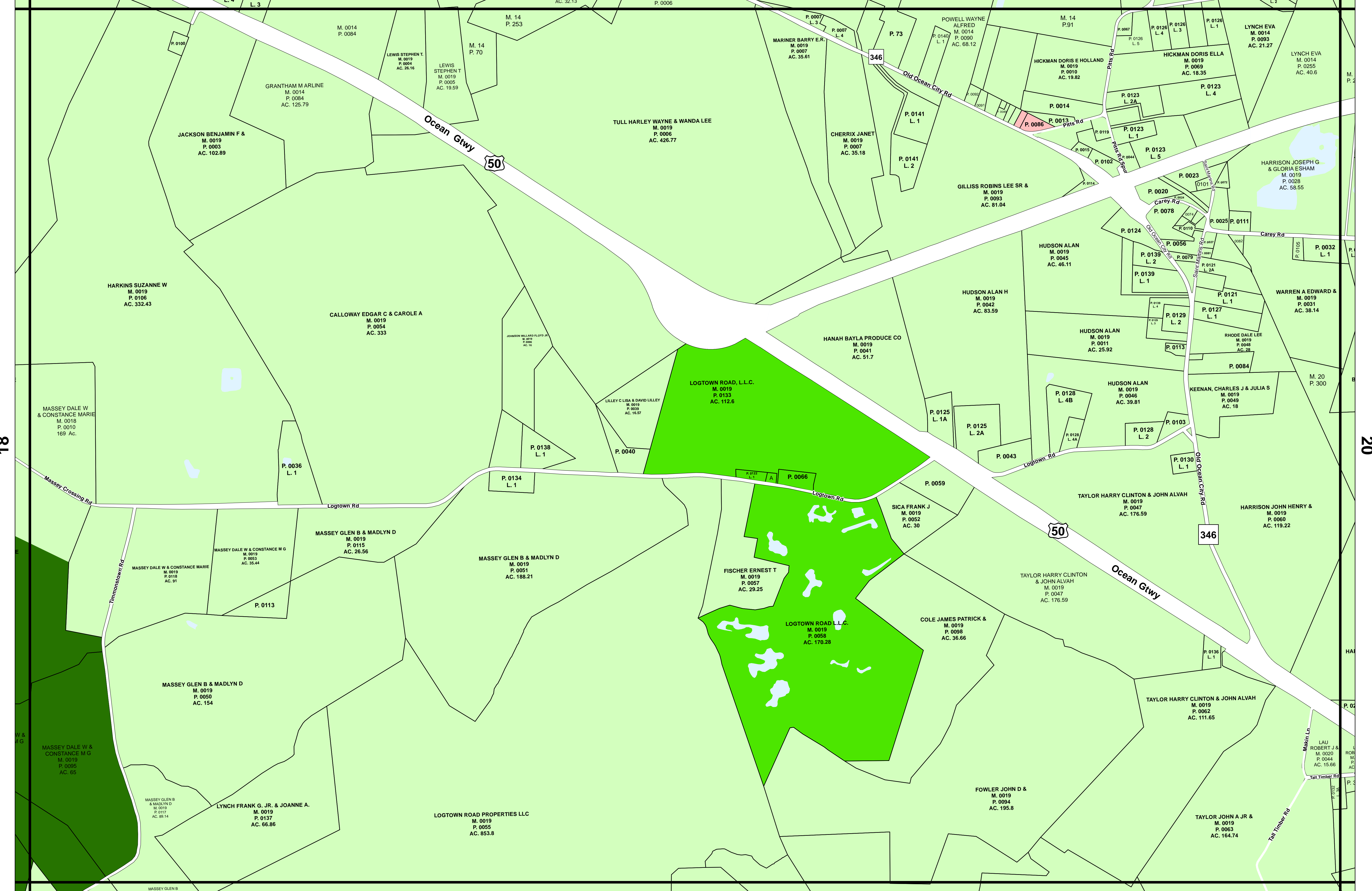

0 300 600 1,200 Feet

Official Zoning Map

Map prepared by Worcester County Department of Development Review and Permitting, November 3, 2009.
Source: Worcester County Commissioners.

| | | | | | | | | | | | |
|--|----|--|----|--|----|--|----|--|----|--|-----|
| | A1 | | RP | | R2 | | I1 | | C1 | | V1 |
| | A2 | | E1 | | R3 | | I2 | | C2 | | MUN |
| | CA | | R1 | | R4 | | CM | | C3 | | |

Tax Map 19

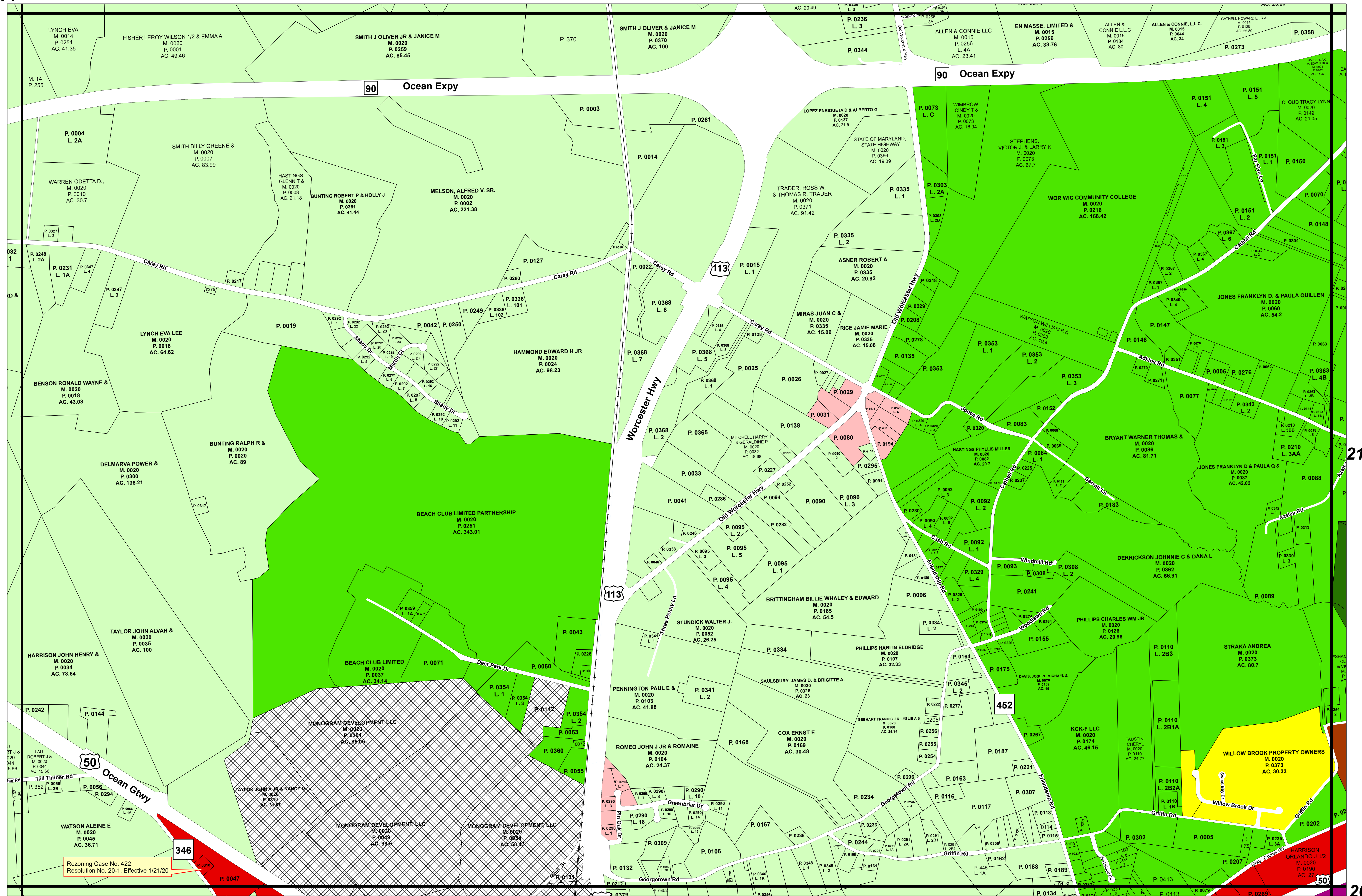

Official Zoning Map

Map prepared by Worcester County Department of Development Review and Permitting, November 3, 2009.
 Source: Worcester County Commissioners.
 Updated: Resolution No. 20-1, Effective 1/21/20, Case No. 422.

| | | | | | |
|----|----|----|----|----|-----|
| A1 | RP | R2 | I1 | C1 | V1 |
| A2 | E1 | R3 | I2 | C2 | MUN |
| CA | R1 | R4 | CM | C3 | |

Tax Map 20